



Plot 1 Langton Park
Offers in excess of
£375,000

richard james



Plot 1 Langton Park

Freehold | EPC Rating - | Council Tax -

 3

 2

 1

Property Description

Each home has been thoughtfully designed to offer spacious interiors with a practical and well-considered layout. Featuring contemporary kitchens positioned at the rear of the property with views onto the garden, generously sized living rooms to the front, and well-proportioned bedrooms, these homes are ideal for growing families, first-time buyers, or those looking to downsize. With the added benefit of private, non over-looked gardens, and allocated parking, everyday living is both comfortable and energy-efficient.

Located in one of Wiltshire's most desirable areas, residents will enjoy excellent access to the M4 and A419, making commuting simple, while the historic market town of Marlborough is just a short drive away. Wroughton itself offers a welcoming community, a range of local amenities, and is well served by reputable schools including Wroughton Infant and Junior School, as well as The Ridgeway School and Sixth Form College.

Please note: Images used are computer-generated (CGIs) and are for illustrative purposes only. Properties due for completion Q4 2025.



Floorplan

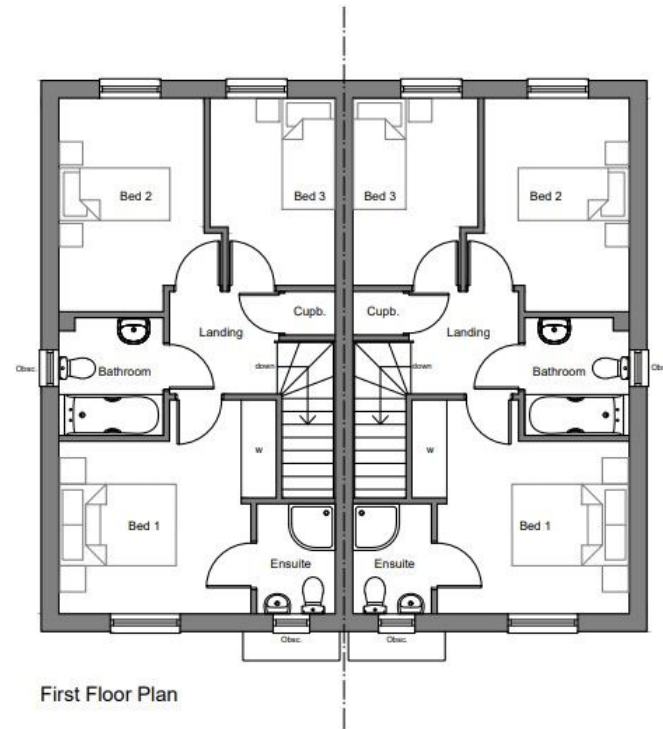
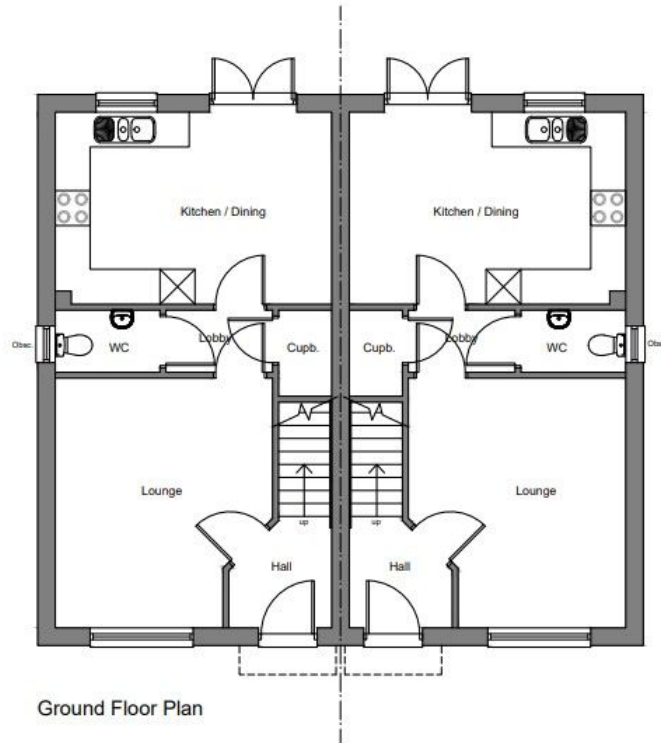

Details are subject to approval

Contact us



Yamuna Reid



01793 688705



newhomes@richardjames.uk



Gemini House | Hargreaves Road | Swindon | SN25 5AZ

richard james

richardjames.uk