

The Cullerns,
Highworth, SN6 7NR

rent

£950 per
month

richard
james

incentivised.com





Energy efficiency
rating

D

A beautifully fully refurbished two double bedroom PART FURNISHED BUNGALOW within walking distance of the High Street in the historical market town of Highworth.

The accommodation comprises of a large entrance porch, a modern kitchen with white goods included, a beautifully extended living room with a high vaulted ceiling and patio doors leading out to the sunroom. The master bedroom is a good size and the second bedroom is also a double. The bathroom has been recently refurbished and converted into a wet room. To the rear of the property is a great sized low maintenance garden, and to the front is a large double driveway.

Available from 8th February 2023.

Council tax band C.



exceptional service

Our team will guide you through the process of buying or selling your home.

We have a team of dedicated sales progressors in place to ensure your purchase or sale runs smoothly through to completion, keeping you in the loop and a close eye on your chain while moving you in as swiftly and smoothly as possible.

- Honest valuations in current market conditions
- Dedicated sales progression team
- Recommended financial advisors
- 5* service from valuation to completion
- Award winning lettings service
- Ahead of the game marketing strategies
- Professional photography
- Social media marketing
- Top listings on Rightmove and Zoopla

call us for a free
valuation on your
property

lettings@richardjames.info

Gemini House | Hargreaves Road | SN25 5AZ

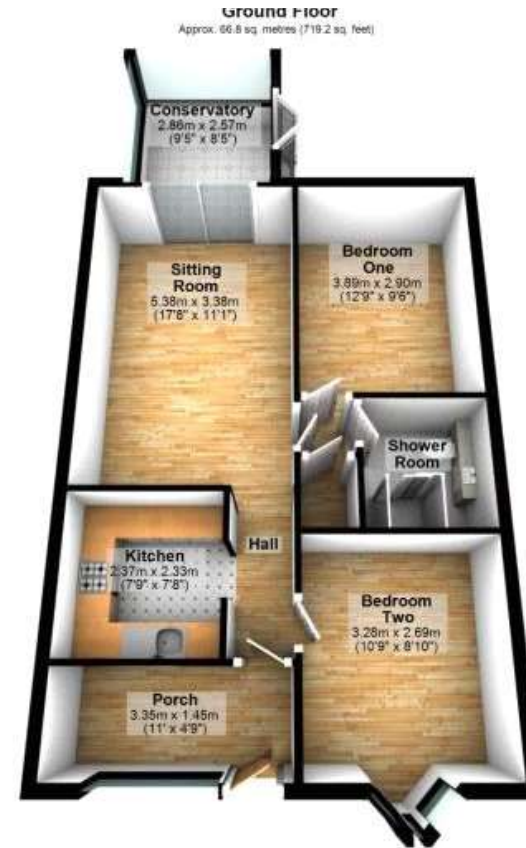

Richard James & their clients give notice that:

1. These sales and particulars do not constitute any part of an offer of contract, and are for the guidance of prospective purchasers only and should not be relied on as statements of fact.
2. No representations are made in these particulars as to the condition of the property or as to whether any service or facilities are in good working order.
3. All Measurements are approximate.

Zoopla

PrimeLocation

rightmove