

Daisy Brook,
Royal Wootton Bassett, SN4 7FF

rent
**£825 per
month**

**richard
james**

incentivised.com





 2  1  1

* energy efficiency
rating

B

This spacious two-bedroom apartment is located in a popular and quiet development in Royal Wootton Bassett, with a nearby local shop and lovely walks by the Wilts and Berks Canal. The property comprises of entrance hall with storage cupboard, bathroom with shower, two double bedrooms, a modern fitted kitchen and a good sized lounge/diner. Externally the property benefits from an allocated parking space as well as a large private locked storage area. Offered part furnished and available 1st March.

•



exceptional service

Our team will guide you through the process of buying or selling your home.

We have a team of dedicated sales progressors in place to ensure your purchase or sale runs smoothly through to completion, keeping you in the loop and a close eye on your chain while moving you in as swiftly and smoothly as possible.

- Honest valuations in current market conditions
- Dedicated sales progression team
- Recommended financial advisors
- 5* service from valuation to completion
- Award winning lettings service
- Ahead of the game marketing strategies
- Professional photography
- Social media marketing
- Top listings on Rightmove and Zoopla

call us for a free
valuation on your
property

lettings@richardjames.info

Gemini House | Hargreaves Road | SN25 5AZ

First Floor

Approx. 64.0 sq. metres (688.9 sq. feet)

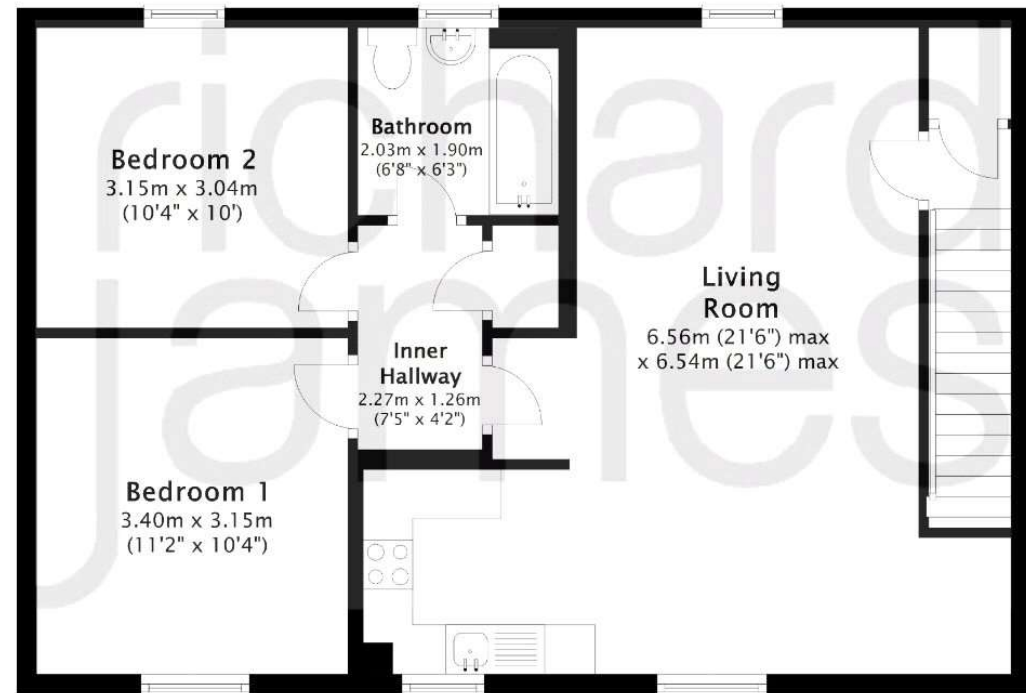

Total area: approx. 64.0 sq. metres (688.9 sq. feet)

Richard James & their clients give notice that:

1. These sales and particulars do not constitute any part of an offer of contract, and are for the guidance of prospective purchasers only and should not be relied on as statements of fact.
2. No representations are made in these particulars as to the condition of the property or as to whether any service or facilities are in good working order.
3. All Measurements are approximate.

Zoopla

PrimeLocation

rightmove